

Premises Licence

THE LICENSING AUTHORITY
FENLAND DISTRICT COUNCIL
FENLAND HALL
COUNTY ROAD
MARCH
CAMBS PE15 8NQ

Premises licence number:

PREM 0350

PART 1 – PREMISES DETAILS

Postal address of premises, or if none, ordnance survey map reference or description:

Haran's 10 Norfolk Street

Post town:	Wisbech	Post code:	PE13 3LD
-------------------	---------	-------------------	----------

Telephone number:	01945 429740
--------------------------	--------------

Where the licence is time limited, the dates:

Not applicable

Licensable activities authorised by the licence:

Sale by Retail of Alcohol

The times the licence authorises the carrying out of licensable activities:

Sale by Retail of Alcohol

Monday to Sunday 06:00 – 24:00

The opening hours of the premises:

Monday to Sunday 06:00 – 24:00

Where the licence authorises supplies of alcohol, whether these are on and/or off supplies:

OFF

PART 2

Name, (registered) address, telephone number and e-mail (where relevant) of holder of premises licence:

Mr Kanapathipillai Kumaravel Thivakaran
Haran Cottage
Osborne Road
Wisbech
Cambridgeshire
PE13 3JX

01945 429740

Registered number of holder; for example, company number, charity number (where applicable):

Not applicable

Name, address and telephone number of designated premises supervisor where the premises licence authorises the supply of alcohol:

Mr Kanapathipillai Kumaravel Thivakaran
Haran Cottage
Osborne Road
Wisbech
Cams
PE13 3JX

01945 429740

Personal licence number and issuing authority of personal licence held by designated premises supervisor where the premises licence authorises the supply of alcohol:

CAM000241

Cambridge City Council

Licence valid from: 10 February 2012

Date of Issue: 15 February 2012

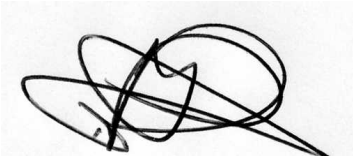

.....
SAFER FENLAND MANAGER

Annex 1 – Mandatory Conditions

Mandatory Conditions: Premises Licence – Sale by Retail of Alcohol – Off Sales

1. No supply of alcohol may be made under the premises licence:
 - (a) at a time when there is no designated premises supervisor in respect of the premises licence, or
 - (b) at a time when the designated premises supervisor does not hold a personal licence or his/her personal licence is suspended.
2. Every supply of alcohol under the premises licence must be made or authorised by a person who holds a personal licence.

Mandatory Conditions: Premises Licence – Age Verification Policy – Off Sales

1. The premises licence holder or club premises certificate holder shall ensure that an age verification policy applies to the premises in relation to the sale or supply of alcohol.
2. The policy must require individuals who appear to the responsible person to be under 18 years of age (or such older age as may be specified in the policy) to produce on request, before being served alcohol, identification bearing their photograph, date of birth and a holographic mark.

Annex 2 – Conditions Consistent with the Operating Schedule

1. Full alarm system to be installed on the premises and maintained in good working order.
2. Spirits to be located behind counter area.
3. Frequent and ongoing staff refresher training to be carried out with regard to alcohol sales.
4. CCTV system to record digitally at all times the premises is open for licensable activities and recordings to be made available by authorised staff to the police upon reasonable request for up to 31 days.
5. Appropriate staff training to be satisfactorily completed and recorded.
6. Frequent and ongoing staff refresher training to be carried out with regard to alcohol sales.
7. Training records to be made available for inspection upon reasonable request by a relevant officer of a Responsible Authority.
8. Appropriate training manual, refusals book to be maintained within the premises and operated by all staff, challenge 21 and pass accredited proof of age initiative to be operated by all staff.
9. Worded notices to be displayed in store prominently advising staff and customers of their responsibilities under the licensing legislation.
10. Appropriately worded notices displayed in store prominently requesting customers to leave the premises quietly at night.

Annex 3 – Conditions Attached after a Hearing by the Licensing Authority

The determination of the Licensing Committee on 27 June 2011 in respect of an application for a premises licence was granted subject to amendments as follows:

- **The amended hours of:**
 - **06:00 – 12 midnight for the sale of alcohol (off sales)**
 - **06:00 – 12 midnight hours the premises are open to the public;**
- **The display and sale of alcohol is only to be within the designated areas as shown on the original plan (subject to the minor amendment of tobacco sales);**
- **Any such conditions as are consistent with the Operating Schedule accompanying the application for the promotion of the four licensing objectives;**
- **Any mandatory conditions included in the licence;**
- **The conditions consistent with the Operating Schedule for 11 Norfolk Street as listed in Annex 2 of that licence, unless they are duplicated;**
- **The applicant MUST maintain a premises guidance manual in the form submitted to the committee today (The manual should be kept up to date and available to the Police on request)**

Annex 4 – Plans



- Key**
- ◇ Security Camera
 - ⊠ Fire Extinguisher - Water

Haran's - All in One Store
 10 Norfolk Street
 Wisbech
 PE13 2LD
 Scale 1:100
 Drawing Reference: RB 0679
 Drawn by Richard Baker - RB Retail & Licensing
 9TH May 2011

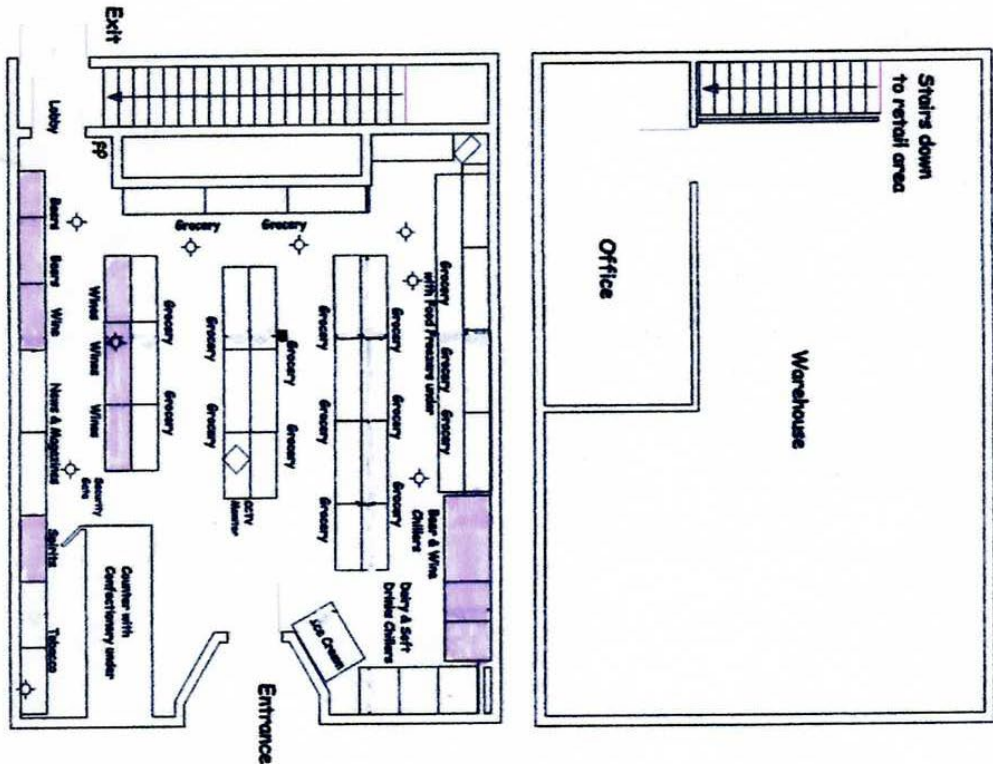

All retail selling areas to be licensed for alcohol display. Copyright - RB Retail & Licensing Services Limited
 23 Mogster Drive, Lee on the Solent, Portsmouth, PO13 8GE. Do not scale from drawing. Site dimensions to be used at all times.
 All retail area to be licensed

Premises Licence Summary

THE LICENSING AUTHORITY
FENLAND DISTRICT COUNCIL
FENLAND HALL
COUNTY ROAD
MARCH
CAMBS PE15 8NQ

Premises licence number:

PREM 0350

PREMISES DETAILS

Postal address of premises, or if none, ordnance survey map reference or description:

Haran's 10 Norfolk Street

Post town:	Wisbech	Post code:	PE13 3LD
-------------------	---------	-------------------	----------

Telephone number:	01945 429740
--------------------------	--------------

Where the licence is time limited, the dates:

Not applicable

Licensable activities authorised by the licence:

Sale by Retail of Alcohol

The times the licence authorises the carrying out of licensable activities:

Sale by Retail of Alcohol

Monday – Sunday 06:00 – 24:00

The opening hours of the premises:

Monday – Sunday 06:00 – 24:00

Where the licence authorises supplies of alcohol, whether these are on and/or off supplies:

OFF

Name, (registered) address, telephone number and e-mail (where relevant) of holder of premises licence:

Mr Kanapathipillai Kumaravel Thivakaran
Haran Cottage
Osborne Road
Wisbech
Cambridgeshire
PE13 3JX

01945 429740

Registered number of holder; for example, company number, charity number (where applicable):

Not applicable

Name of designated premises supervisor where the premises licence authorises for the supply of alcohol:

Mr Kanapathipillai Kumaravel Thivakaran

State whether access to the premises by children is restricted or prohibited:

Not applicable